

**Coarse Strainer
Type LKVF**

6

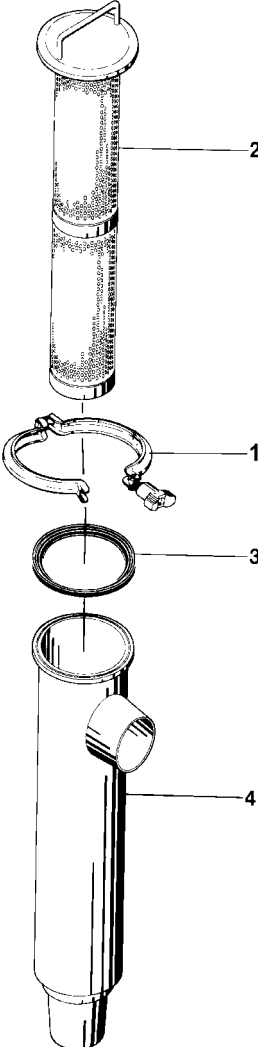

Coarse Strainer Type LKVF

| Pos. | Qty. | Denomination | 25 mm | 38 mm | 51 mm | 63.5 mm | 76 mm |
|------|------|----------------------------------------|--------------|--------------|--------------|--------------|--------------|
| 1 | 1 | Clampring | 9611-99-1510 | 9611-99-1510 | 9611-99-1510 | 9611-99-1512 | 9611-99-1512 |
| 2 | 1 | Strainer element * \varnothing 1.0.. | 9612-1906-01 | 9612-1906-01 | 9612-1906-01 | 9612-1914-01 | 9612-1914-01 |
| | 1 | Strainer element * \varnothing 2.0.. | 9612-1906-03 | 9612-1906-03 | 9612-1906-03 | 9612-1914-03 | 9612-1914-03 |
| | 1 | Strainer element * \varnothing 3.0.. | 9612-1906-05 | 9612-1906-05 | 9612-1906-05 | 9612-1914-05 | 9612-1914-05 |
| 3 | 1 | Seal ring EPDM | 9611-99-1361 | 9611-99-1361 | 9611-99-1361 | 9611-99-1363 | 9611-99-1363 |
| | 1 | Seal ring NBR | 9611-99-0768 | 9611-99-0768 | 9611-99-0768 | 9611-99-0770 | 9611-99-0770 |
| | 1 | Seal ring PTFE | 9611-99-1406 | 9611-99-1406 | 9611-99-1406 | 9611-99-1408 | 9611-99-1408 |
| 4 | 1 | Strainer casing | 9612-4218-01 | 9612-4218-02 | 9612-4218-03 | 9612-4218-04 | 9612-4218-05 |